

# Capsule Pressure Gauges

**PCS063, PCS100**  
**PCX100, PCX150**



For measurement of low pressure and vacuum within the range -600...0 to 0...600 mbar, for use on gas and dry air.

## Functional and constructive characteristics

### PCS063... (without filling)

**Accuracy class** : 1.6 as per EN 837.  
**Ambient temperature** : -25...+65°C.  
**Process temperature** : +50°C.  
**Overpressure** : 25% of full scale value.  
**Socket material** : nickel plated brass.  
**Elastic element** : phosphor bronze capsule  
**Case** : stainless steel.  
**Ring** : stainless steel.  
**Window** : glass.  
**Movement** : brass.  
**Dial** : aluminium, white with black marking.  
**Special dial** : ranges different from standard, available on request.  
**Pointer** : aluminium alloy.  
**Blow out vent** : EPDM.

### PCS100... (without filling)

**Accuracy class** : 1.6 as per EN 837.  
**Ambient temperature** : -25...+65°C.  
**Process temperature** : +65°C.  
**Overpressure** : 25% of full scale value.  
**Socket material** : AISI 303 st.st.  
**Elastic element** : phosphor bronze capsule.  
**Case** : stainless steel.  
**Ring** : stainless steel.  
**Window** : glass.  
**Movement** : brass.  
**Dial** : aluminium, white with black marking.  
**Special dial** : ranges different from standard, available on request.  
**Pointer** : aluminium alloy.  
**Blow out vent** : EPDM

### PCX100-150... (without filling)

**Process temperature** : +100°C.  
**Socket material** : AISI 316 st.st.  
**Elastic element** : AISI 316 Ti st.st.(1.4571) capsule  
**Other characteristics** : as type PCS100.

**Options** : on request

# PCS063

## TYPE AND DIMENSIONS

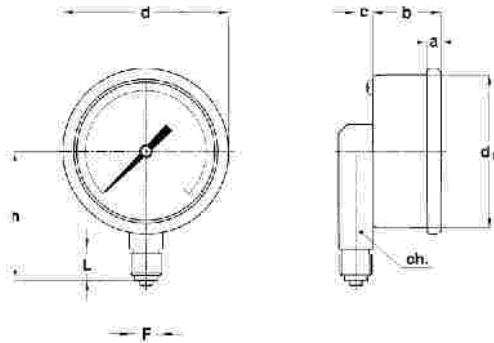

### TYPE A

Stem mounting; lower connection

DS	Type	a	b	c	d	d <sub>1</sub>
63	A	5.6	28	7	68	62.6

(dimensions in mm.)

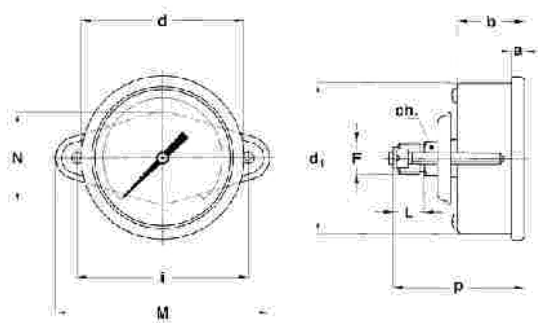

### TYPE H

Flush mounting, «U»-Clamp; back connection

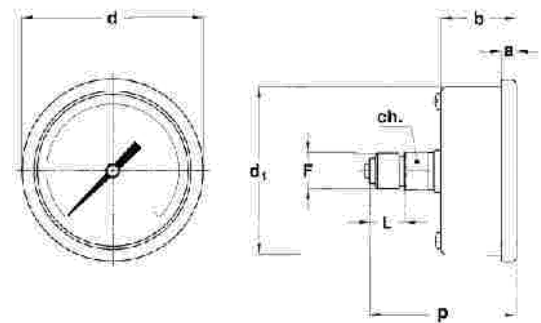

### TYPE C

Stem mounting; back connection

DS	Type	a	a <sub>2</sub>	b	d	d <sub>1</sub>	D	E	f	i	M	N
63	H-C-J	5.6	6.6	28	68	62.6	85	75	3.6	72	90	38

(dimensions in mm.)

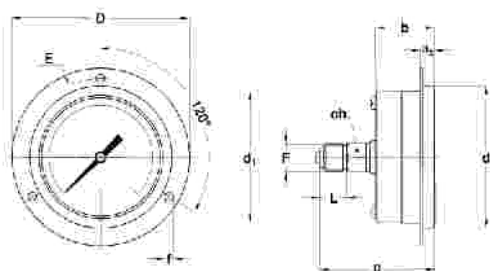

### TYPE J

Flush mounting, front flange; back connection

### PROCESS CONNECTION

F	L	ch	h	p
1/4" BSP	13	14	53	54.8
1/4" NPT	13	14	53	53.8

(dimensions in mm)

# PCS100, PCX100, PCX150

## TYPE AND DIMENSIONS

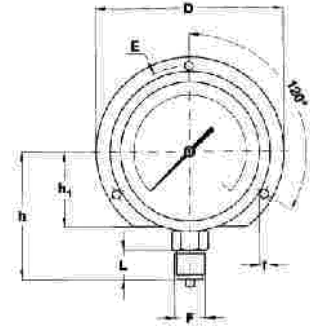
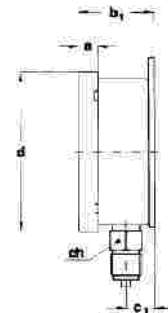
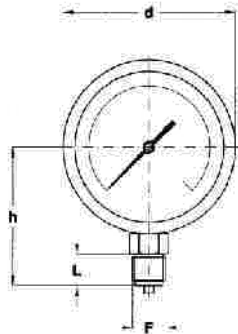
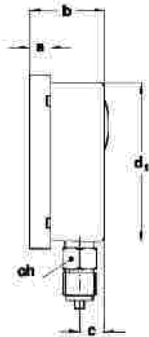

### TYPE A

Stem mounting; lower connection

### TYPE B

Surface mounting; back flange; lower connection

DS	Type	a	b	b <sub>1</sub>	c	c <sub>1</sub>	d	d <sub>1</sub>	f	h <sub>1</sub>	D	E
100	A-B	13	48.6	52.6	16.1	20.1	110.6	101	6	52	130	118
150	A-B	15	50.5	54	16.5	20	161	149.6	6	85	190	175

(dimensions in mm.)

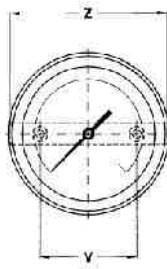
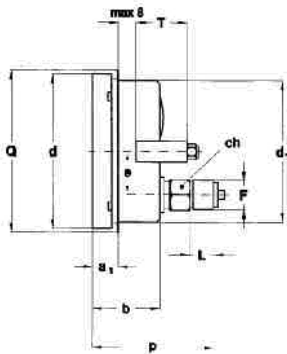

### TYPE H

Flush mounting, «U»-Clamp; back connection

### TYPE C

Stem mounting; back connection

DS	Type	a	a <sub>1</sub>	a <sub>2</sub>	b	d	d <sub>1</sub>	e	f	h <sub>1</sub>	p	D	E	Q	T	V	Z
100	H-C-J	13	20	20	48.6	110.6	101	31	6	-	86.8	132	118	112	41.5	70	112
150	H-C-J	15	20.5	25.5	50.5	161	149.6	31	6	85	85	190	175	164	41.5	106	155

(dimensions in mm.)

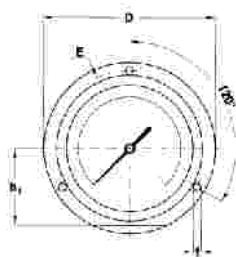
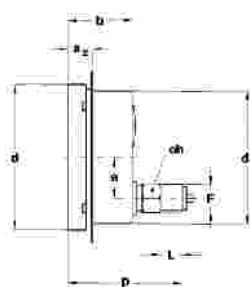

### TYPE J

Flush mounting, front flange; back connection

## PROCESS CONNECTION

F	L	ch	h	p
1/2" BSP	20	22	86	86.6
1/2" NPT	20	22	86	86.6

(dimensions in mm)

# PCS063, PCS100

# PCX100, PCX150

**RANGES** - «C» = Available for PCS063; «E» = available for PCS100 & PCX100; «G» = Available for PCX150.

## PRESSURE

TAB. 1

RANGES (1)	PCS	PCX
0...6 mbar		G
0...10 mbar		G
0...16 mbar		G
0...25 mbar	E	EG
0...40 mbar	E	EG
0...60 mbar	CE	EG
0...100 mbar	CE	EG
0...160 mbar	CE	EG
0...250 mbar	CE	EG
0...400 mbar	CE	EG
0...600 mbar	CE	EG

## VACUUM (2)

TAB. 2

RANGES (1)	PCS	PCX
-0...6 mbar		G
-0...10 mbar		G
-0...16 mbar		G
-0...25 mbar	E	EG
-0...40 mbar	E	EG
-0...60 mbar	CE	EG
-0...100 mbar	CE	EG
-0...160 mbar	CE	EG
-0...250 mbar	CE	EG
-0...400 mbar	CE	EG
-0...600 mbar	CE	EG

## COMPOUND (2)

TAB. 3

RANGES (1)	PCS	PCX
-2...4 mbar		G
-4...2 mbar		G
-3...3 mbar		G
-4...6 mbar		G
-5...5 mbar		G
-6...10 mbar		G
-10...6 mbar		G
-10...15 mbar	L	LG
-15...10 mbar	F	EG
-15...25 mbar	E	EG
-25...15 mbar	L	EG
-20...40 mbar	CE	EG
-40...20 mbar	CF	EG
-40...60 mbar	CE	EG
-60...40 mbar	CF	EG
-60...100 mbar	CE	EG
-100...60 mbar	CL	LG
-100...150 mbar	CE	EG
-150...100 mbar	CE	EG
-150...250 mbar	CE	EG
-250...150 mbar	CE	EG
-200...400 mbar	CF	EG
-400...200 mbar	CE	EG